

OWIDNR252010-R47

SMD Power inductor



Description

Half-shielded magnetic epoxy core

Features

RoHS, Halogen Free and REACH Compliance
 Shielded and miniature design
 Shielded power inductor
 Side soldering process

Applications

Smartphones, tablets and wearable devices DSC, camcorders DC/DC converters etc.

General Specifications

| | |
|---|------------------------------------|
| Test Voltage | 0.1V |
| Parameters Test Temp | 25°C |
| Operation Temp (Including temperature Rise) | -40 to +125°C |
| Storage Temp | 0 to 40°C |
| Storage Humidity | <70% RH |
| Resistance to Soldering Heat | 260°C for 10 sec |
| Rated Current | L drops off 30% typ at Isat |
| Temperature Rise | 40°C typ. at Irms |

| Inductance | Ltol. | Test freq. | DCR [mΩ] | Isat [A] | Irms [A] | Irated [mA] | Idc max [mA] | Q (min) | SRF[MHz] |
|------------|---------|------------|----------|----------|----------|-------------|--------------|---------|----------|
| 0.47 uH | M, P, N | 1MHz | 44.00 | 2.50 | 2,5 | | | | |

When ordering please specify tolerance code Tolerance: M=±20%, P=±25%, N=±30%

Shape and dimensions [mm]

| A | B | C | D | E | F | G | H | I | J | Shape |
|------------|-----------|------|------|-----|---|---|-----|------|-----|-------|
| 2.00 | 2.50 | 1.05 | 0.82 | 2.6 | | | 2.6 | 1.25 | 0.6 | |
| +0.35 -0.1 | +0.3 -0.1 | Max | Ref | Ref | | | Ref | Ref | Ref | |

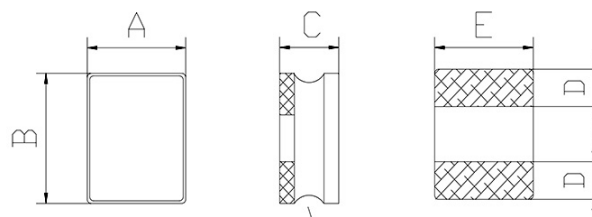

Magnetic shielding

