

# OWIDNR252010-R68

## SMD Power inductor



### Description

Half-shielded magnetic epoxy core

### Features

RoHS, Halogen Free and REACH Compliance  
 Shielded and miniature design  
 Shielded power inductor  
 Side soldering process

### Applications

Smartphones, tablets and wearable devices DSC, camcorders DC/DC converters etc.

### General Specifications

Test Voltage	0.1V
Parameters Test Temp	25°C
Operation Temp (Including temperature Rise)	-40 to +125°C
Storage Temp	0 to 40°C
Storage Humidity	<70% RH
Resistance to Soldering Heat	260°C for 10 sec
Rated Current	L drops off 30% typ at Isat
Temperature Rise	40°C typ. at Irms

Inductance [ $\mu$ H]	Ltol.	Test freq.	DCR [ $m\Omega$ ]	Isat [A]	Irms [A]	Irated [mA]	Idc max [mA]	Q (min)	SRF[MHz]
0.68	M, P, N	1MHz	65.00	2.45	2,2				

When ordering please specify tolerance code Tolerance: M= $\pm$ 20%, P= $\pm$ 25%, N= $\pm$ 30%

## Shape and dimensions [mm]

A	B	C	D	E	F	G	H	I	J	Shape
2.00	2.50	1.05	0.82	2.6			2.6	1.25	0.6	
+0.35 -0.1	+0.3 -0.1	Max	Ref	Ref			Ref	Ref	Ref	

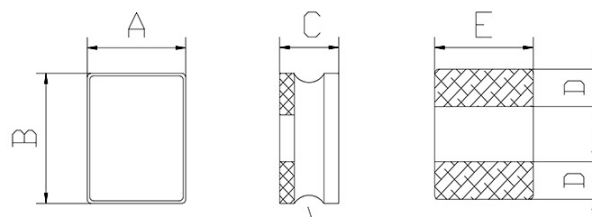

Magnetic shielding

