



IPX8 COMPLIANT DYNAMIC SPEAKER OWS-111535L-8C



CHARACTERISTICS

| | |
|-------------------------------|--|
| Impedance [Ω] | 7.2 \pm 15% @ 2 kHz |
| SPL [dB rel 20 μ Pa] | 112 \pm 3 @ 2kHz / 2.53 V / 1cm in 1cc box |
| Resonance Frequency [Hz] | 950 \pm 20% in 1cc box / 2.53 Vrms |
| Total Harmonic Distortion [%] | As shown in graph |
| Input Power (nom./max) [W] | In 1cc box: 0.8 / 1.2 |
| Termination* | Leaf spring |

*For other termination options please contact sales@owolff.com or your local Ole Wolff representative.

PHYSICAL DIMENSIONS [mm]

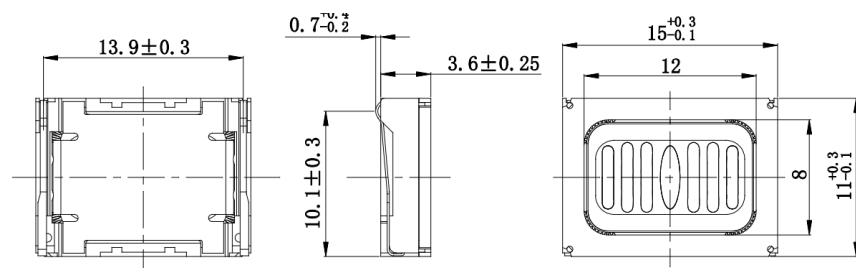

High-end microspeaker
Designed for waterproof applications in portable consumer devices

FEATURES

- **IPx8 waterproof** tested in 1.5m for 30min.
- Leak measurements guarantees IPx8 waterproof compliance.
- Multi-magnet system for improved sensitivity
- 100% in-line verification of specified acoustical and electrical parameters

GRAPHS

Test conditions: 2.53V / 1cm / 1cc box

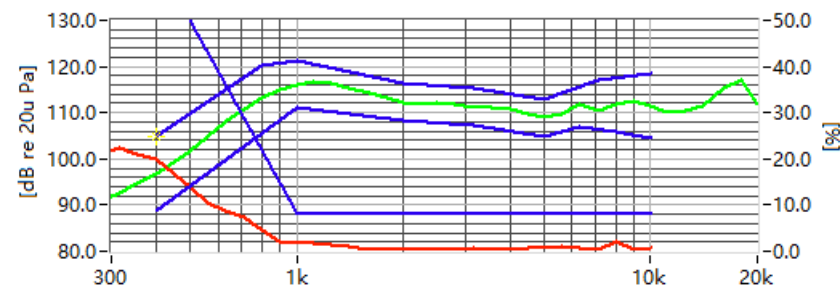

F&R Mask:

| F&R Point | 400 | 800 | 1k | 2k | 3.15k | 5k | 6.3k | 7.1k | 8k | 10k | Hz |
|-------------|-----|-----|----|----|-------|----|------|------|----|-----|----|
| Upper limit | +8 | +7 | +5 | +4 | +4 | +4 | -5 | +7 | -6 | +7 | dB |
| Lower limit | -8 | -7 | -5 | -4 | -4 | -4 | -5 | -7 | -6 | -7 | dB |

THD Mask:

| F&R POINT | 500 | 2k | 10k | Hz |
|-------------|-----|----|-----|----|
| Upper limit | 50 | 8 | 8 | % |