

CHARACTERISTICS

Impedance [Ω]	7.2 \pm 15% @ 2 kHz
SPL [dB rel 20 μ Pa]	114 dB \pm 3 dB at 2kHz /1cm/2.0Vrms in 1.0cc box .Measurement as shown in graph.
Resonance Frequency [Hz]	900 Hz \pm 20% (2.0Vrms in 1.0cc box)
Total Harmonic Distortion [%]	As shown in graph
Input Power (nom./max) [W]	0.8 / 1.2
Termination*	Leaf spring

*For other termination options please contact sales@owolff.com or your local Ole Wolff representative.

PHYSICAL DIMENSIONS [mm]

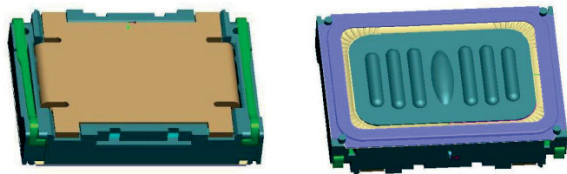
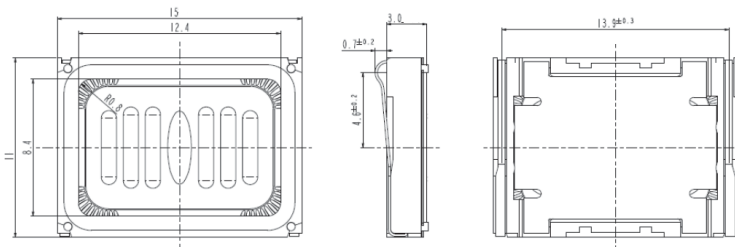

GRAPHS

Test conditions: 1.0cc/ 2Vrms/10mm

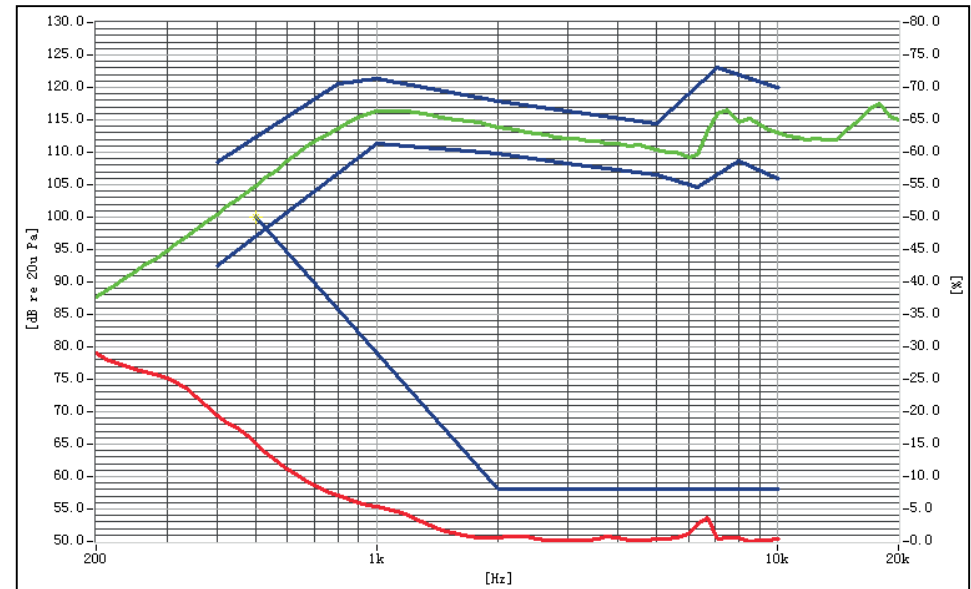

F&R Mask:

F&R Point	400	800	1k	2k	3.15k	5k	6.3k	7.1k	8k	10k	Hz
Upper limit	+8	+7	+5	+4	+4	+4	-	+7	-	+7	dB
Lower limit	-8	-	-5	-4	-4	-4	-5	-	-6	-7	dB

THD Mask:

F&R POINT	500	2k	10k	Hz
Upper limit	50	8	8	%